

MOTORS WITH POWER OVER 1000 W

NK SERIES - Non reversible

WATT: 3100 / CONSUMPTION: 2800 NI/1"

Data sheet
NK70D

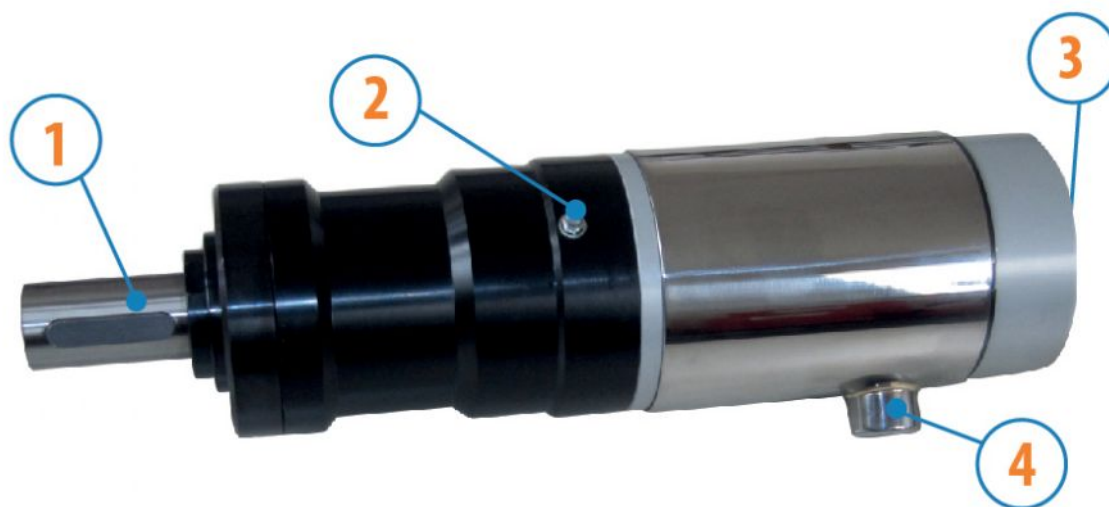

1. Cylindrical keyed shaft
2. Grease gun
3. Air inlet
4. Air exhaust

Technical specification

Right rotation - Model	NK70D
Right rotation - Code	8711260
Speed rpm - No-load	65
Speed rpm - at Max Power	50
Torque Nm - at Max Power	600
Torque Nm - Stall Torque	1450

Form features

The normal delivery condition:
cylindrical shaft and body as shown in the photo.

Optional:

Shaft

- threaded - indication / AF (left rotation excluded - subject to checks for reversible)

- conical - indication / AC

- with collets - indication / AP

Characteristic curves

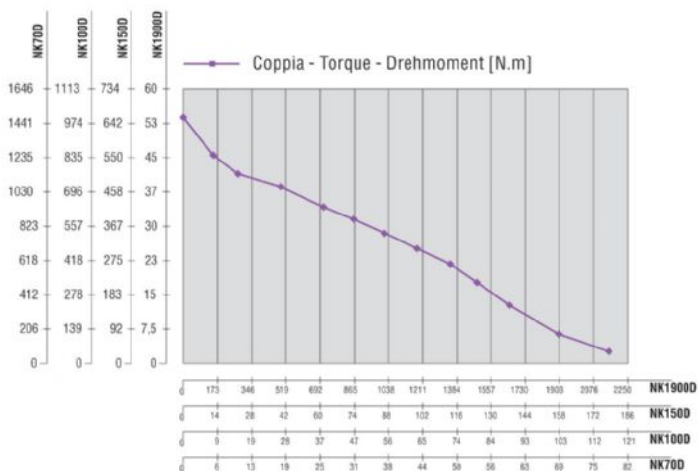

MOTORS WITH POWER OVER 1000 W

NK SERIES - Non reversible

WATT: 3100 / CONSUMPTION: 2800 NI/1"

Data sheet
NK70D

Permissible radial and axial loads

Model	Code	Fr (N)	Fa (N)	Co (N)
NK70D	8711260	11000	8000	54000

Overall dimensions

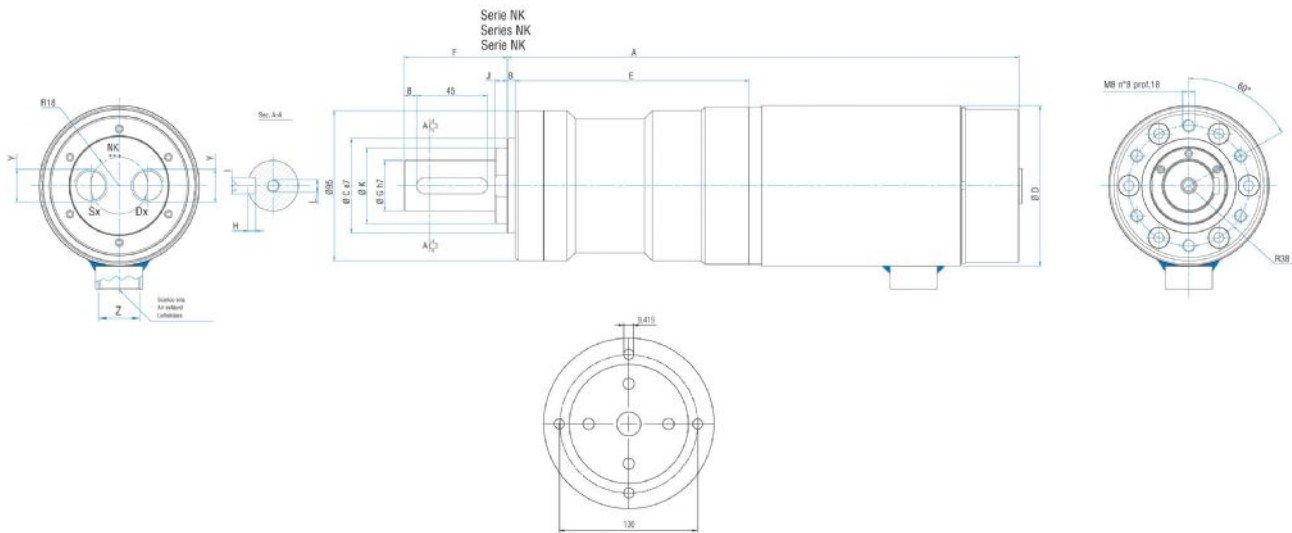

Flange disponibili per alcuni modelli.
Flanges available for some models.
Flansche erhältlich für einige Modelle.

Model	Code	A	B	C	D	E	F	G	H	I	J	K	L	Y	Z
NK70D	8711260	331,8	5	60	101,6	148,3	65,5	62	5	10	7,5	48	M8	1/2"	3/4"