

MOTORS WITH POWER OVER 1000 W

NK SERIES - Non reversible

WATT: 3100 / CONSUMPTION: 2800 NI/1"

Data sheet
NK100S

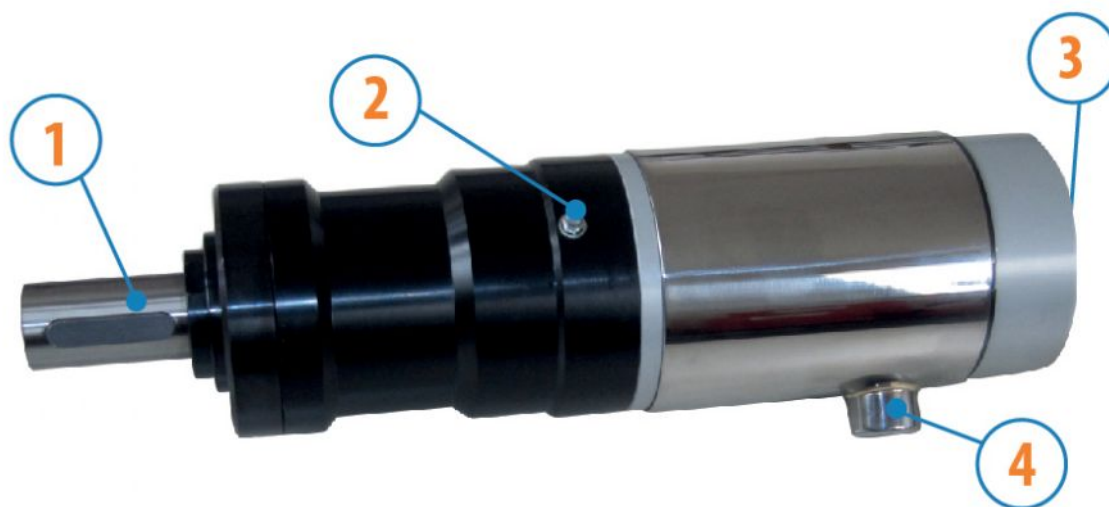

1. Cylindrical keyed shaft
2. Grease gun
3. Air inlet
4. Air exhaust

Technical specification

Left rotation - Model	NK100S
Left rotation - Code	8721261
Speed rpm - No-load	100
Speed rpm - at Max Power	70
Torque Nm - at Max Power	406
Torque Nm - Stall Torque	990

Form features

The normal delivery condition:
cylindrical shaft and body as shown in the photo.

Optional:

Shaft

- threaded - indication / AF (left rotation excluded - subject to checks for reversible)

- conical - indication / AC

- with collets - indication / AP

Characteristic curves

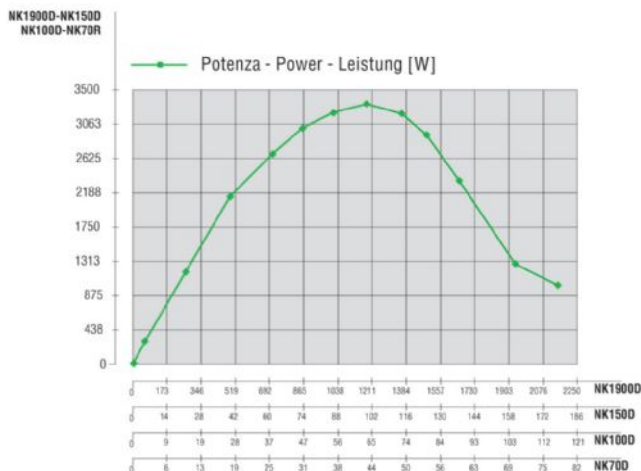
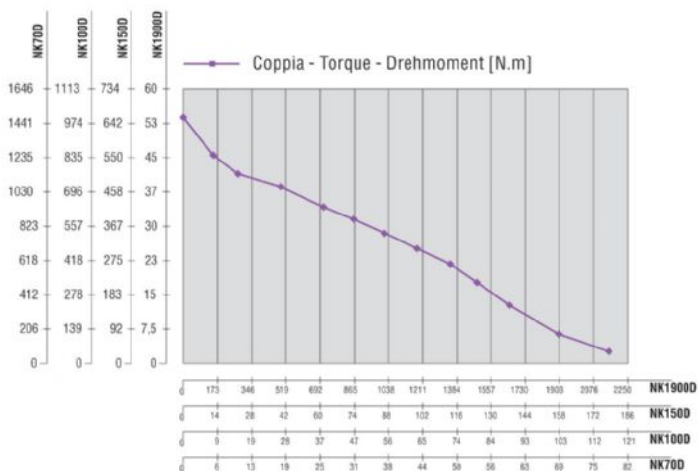

MOTORS WITH POWER OVER 1000 W

NK SERIES - Non reversible

WATT: 3100 / CONSUMPTION: 2800 NI/1"

Data sheet
NK100S

Permissible radial and axial loads

Model	Code	Fr (N)	Fa (N)	Co (N)
NK100S	8721261	11000	8000	54000

Overall dimensions

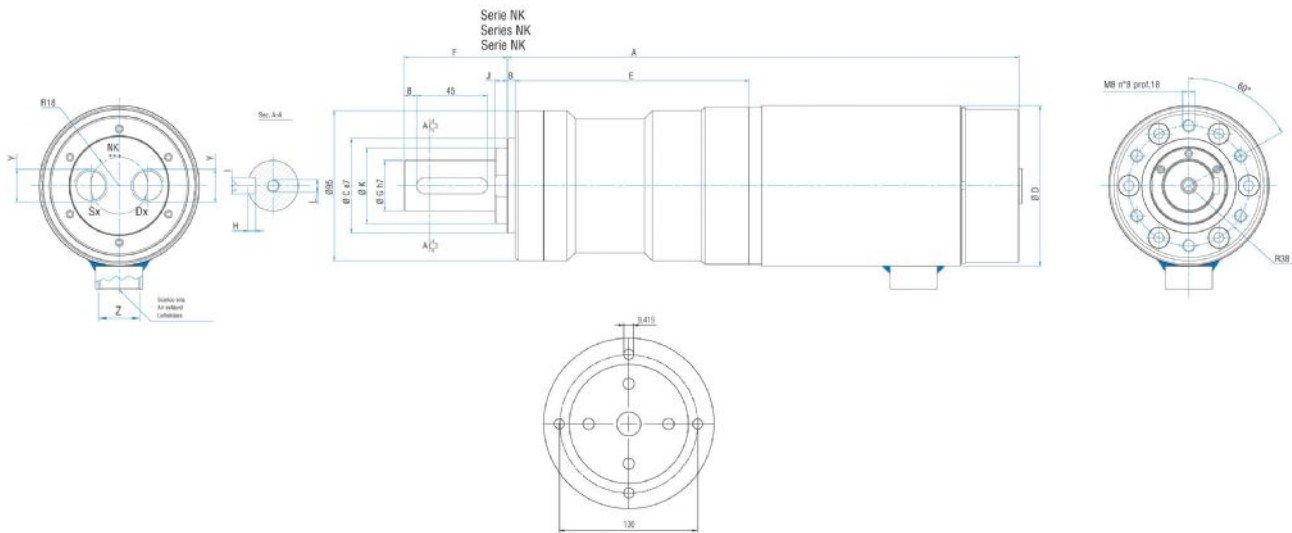

Flange disponibili per alcuni modelli.
Flanges available for some models.
Flansche erhältlich für einige Modelle.

Model	Code	A	B	C	D	E	F	G	H	I	J	K	L	Y	Z
NK100S	8721261	331,8	5	60	101,6	148,3	65,5	32	5	10	7,5	48	M8	1/2"	3/4"