

# MOTORS WITH POWER OVER 1000 W

LKW SERIES - Non reversible

WATT: 1340 / CONSUMPTION: 1400 NI/1'

Data sheet  
**LKW15S**



1. Cylindrical keyed shaft
2. Grease gun
3. Air inlet
4. Air exhaust

## Technical specification

Left rotation - Model	LKW15S
Left rotation - Code	8721242
Speed rpm - No-load	1350
Speed rpm - at Max Power	670
Torque Nm - at Max Power	19,1
Torque Nm - Stall Torque	22,7

## Form features

The normal delivery condition: cylindrical shaft and body as shown in the photo.

Optional:

Shaft

- threaded - indication / AF (left rotation excluded - subject to checks for reversible)

- conical - indication /AC

- with collets - indication / AP

## Characteristic curves

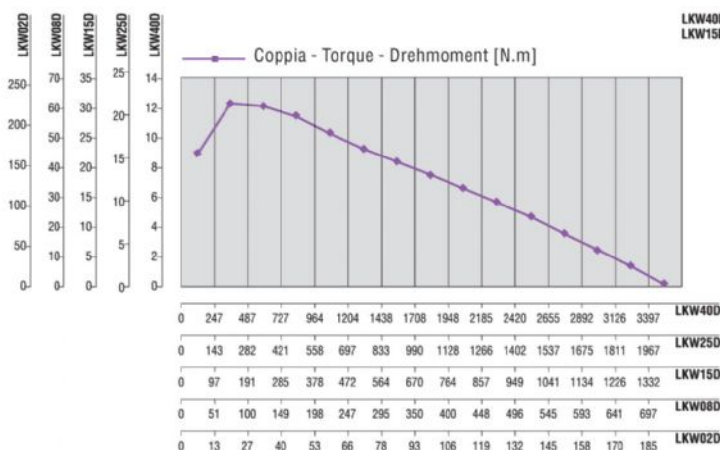

# MOTORS WITH POWER OVER 1000 W

LKW SERIES - Non reversible

WATT: 1340 / CONSUMPTION: 1400 NI/1'

Data sheet  
**LKW15S**

## Permissible radial and axial loads

Model	Code	Fr (N)	Fa (N)	Co (N)
LKW15S	8721242	2850	3900	7800

## Overall dimensions

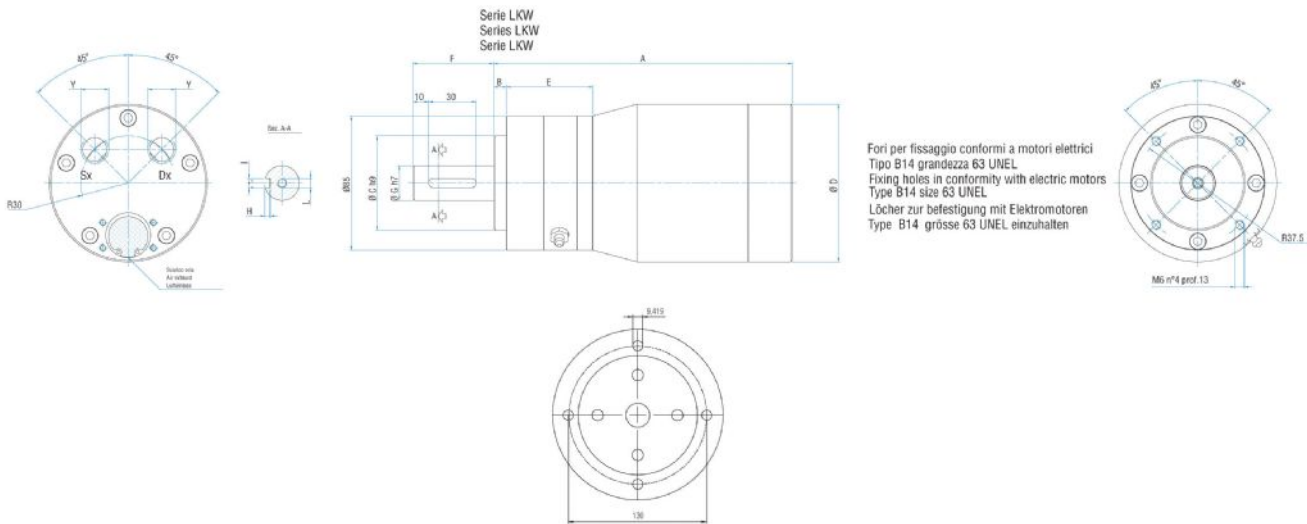

Fori per fissaggio conformi a motori elettrici  
Tipo B14 grandezza 63 UNEL  
Fixing holes in conformity with electric motors  
Type B14 size 63 UNEL  
Löcher zur Befestigung mit Elektromotoren  
Type B14 grösse 63 UNEL einzuhalten

Flange disponibili per alcuni modelli.  
Flanges available for some models.  
Flansche erhältlich für einige Modelle.

Model	Code	A	B	C	D	E	F	G	H	I	J	K	L	Y	Z
LKW15S	8721242	189,2	8	60	100	54,8	51,2	22	3,5	6	/	/	M6	3/8"	/