

Accessori per martelli

Hammer accessories

Zubehör für Hämmer

Scalpello da taglio
Cutting chisel
Schneidmeißel

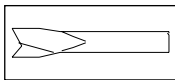

Scalpello piatto
Flat chisel
Flachmeißel

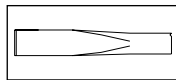

Scalpello per saldatura
Welding chisel
Schweißmeißel



MAC 2 DA	MAC 22/33	MAC 2 DA	MAC 22/33	MAC 2 DA	MAC 22/33
3285951	3285901 *	3285952	3285902 *	3285953	3285903 *

Scalpello per tranciare
Trimming chisel
Trennmeißel

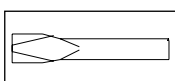

Punteruolo
Drift
Spitzmeißel

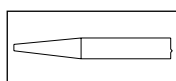

Punzone
Punch
Locher



MAC 2 DA	MAC 22/33	MAC 2 DA	MAC 22/33	MAC 2 DA	MAC 22/33
3285954	3285904	3285955	3285905 *	3285957	3285907

Scalpello piatto doppio taglio
Double cut flat chisel
Flachmeißel mit Doppelschneide

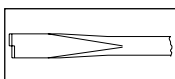

Cacciavite
Screwdriver
Schraubendreher

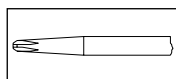

Molla
Spring
Feder

MAC 2 DA	MAC 22/33	MAC 2 DA	MAC 22/33	MAC 2 DA	MAC 22/33
-	3285914 *	3285956	3285906	5084002	5083006

Spianatore
Flattener
Richtmeißel

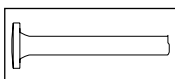

Ribaditore
Riveter
Nietmeißel

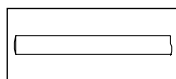

MAC 2 DA	MAC 22/33	MAC 2 DA	MAC 22/33
3285958	3285908	3285959	3285909

* Corredo MAC33 Extra, vedi pag. 6.3 - MAC33 Extra kit, see page 6.3 - Ausstattung MAC33 Extra, siehe Seite 6.3.

Accessori per rivettatrice

Accessories for riveters

Zubehör für Nietwerkzeuge

Kit di riattrezzamento

Retooling kit

Umrüstset

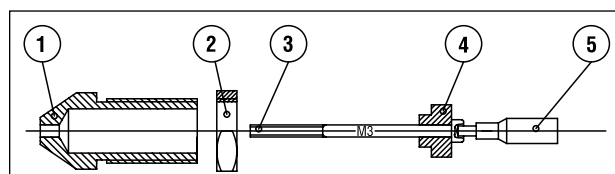

Codice Code Bestellnr.		Naso Tip Nase 1	Dado Nut Mutter 2	Vite Screw Schraube 3	Boccola Bush Buchse 4	Inserto Insert Einsatz 5
7980173	M3	5100047.13	5100612	0320360.1	5063127	3631962
7980174	M4	5100047.14	5100612	0320460.1	5063121.04	3631933
7980175	M5	5100047.15	5100612	0320570.1	5063121.05	3631934
7980176	M6	5100047.16	5100612	0320670.1	5063121.06	3631935



Accessori per stilo marcatrice

Accessories for engraving stylus

Zubehör für Gravierstift

Punta
Marking stylus
Spitze

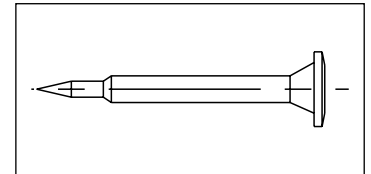

Codice / Code / Bestellnr. | F501106.01

Accessori per seghetto

Accessories for hacksaw

Zubehör für Stichsäge

Lame
Blade
Klinge

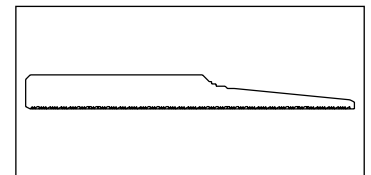

Codice Code Bestellnr.	cod. conf. 5 pz. code for 5-pack Bestellnr. 5-Stück-Packung	Impieghi Uses Einsatzbereich	Configurazione lama Blade specification Sägeblattausführung
3289005	7980110	Ferro, lamiera spessore max mm 2, tagli in curva Sheet metal, max. thickness 2 mm, curve cutting Stahlblech, max. Stärke 2 mm, Bogenschnitte	32 denti per pollice 32 teeth per inch 32 Zähne pro Zoll
3289007	7980111	Ferro max mm 5 - alluminio - legno duro - mat. sintetici Ferrous metal, max. 5 mm - aluminium - hardwood - synthetic material Stahl, max. 5 mm - Aluminium - Hartholz - Kunststoffe	24 denti per pollice 24 teeth per inch 24 Zähne pro Zoll
3289015	7980113	Legno Wood Holz	18 denti per pollice 18 teeth per inch 18 Zähne pro Zoll
3289016	-	Legno Wood Holz	14 denti per pollice 14 teeth per inch 14 Zähne pro Zoll
3289025	-	Gomma tenera - stoffa - cartone - polistirolo Soft rubber - fabric - cardboard - polystyrene Weichgummi - Stoff - Karton - Polystyrol	a coltello knife blade Messor
3289040	-	Marmo - vetroresina Marble - glass fibre Marmor - Glasfaserkunststoff	diamantata fine fine diamond Diamant fein
3289041	-	Marmo - vetroresina Marble - glass fibre Marmor - Glasfaserkunststoff	diamantata media medium diamond Diamant mittel
3289042	-	Marmo - vetroresina Marble - glass fibre Marmor - Glasfaserkunststoff	diamantata grossa coarse diamond Diamant grob

Accessori per rifilatori

Accessories for trimmer

Zubehör für Kantenfräsen

Fresa
Miller
Fräser

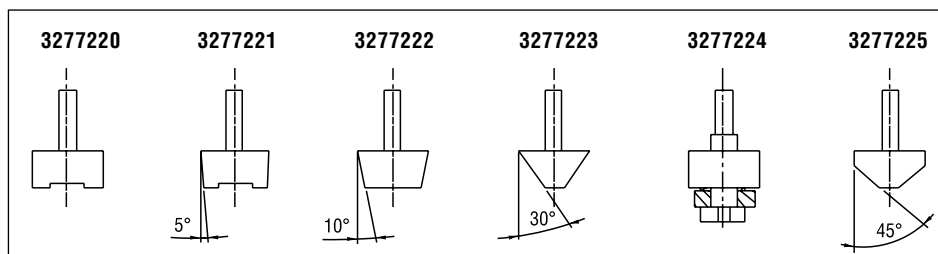

Codice / Code / Bestellnr.	3277220	3277221	3277222	3277223	3277224	3277225
gambo / shank / Schaft	6	6	6	6	6	6
ø mm						
taglienti riportati in widia Widia tipped cutters Hartmetall-bestückte Schneiden	PARALLELA PARALLEL PARALLEL	INCLINATA 5° 5° ANGLE GENEIGT 5°	INCLINATA 10° 10° ANGLE GENEIGT 10°	INCLINATA 30° 30° ANGLE GENEIGT 30°	CON RULLINO WITH ROLLER MIT ROLLE	SMUSSO A 45° 45° BEVEL FASE 45°
ø max mm 21						

Pinze
Collets
Spannzangen

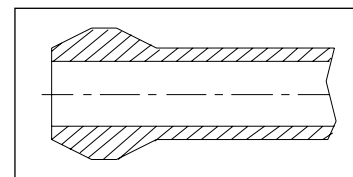

Codice / Code / Bestellnr.	5132102	5132137
ø mm	6	1/4

Chiavi a bocca per serraggio pinza
Collet spanner (open-ended)
Maulschlüssel für Spannzange

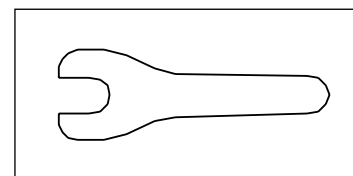

Codice / Code / Bestellnr.	3649104
mm	14